



4 Bramley Close, East Hanney, Wantage, Oxfordshire, OX12 0JX

A well presented two bedroom terraced house situated in the beautiful village of East Hanney. This impressive house comprises an entrance hall, Kitchen with space for a fridge, a freezer and washing machine, a bright and airy lounge that leads onto a pretty South West facing rear garden with rear access. On the first floor there are two bedrooms, built in wardrobes and a bathroom. The property also benefits from two allocated parking spaces.

East Hanney is a thriving village, three miles north of Wantage. The charming Hanney villages amenities include public houses, restaurants, community shop, post office, churches and St James C of E primary school. There are also a number of outstanding private schools locally. The village has excellent links via the A34 with the M40 to the north and the M4 to the south. Didcot railway station c.7.4 miles

**THOMAS
MERRIFIELD**

SALES LETTINGS

£280,000



GROUND FLOOR

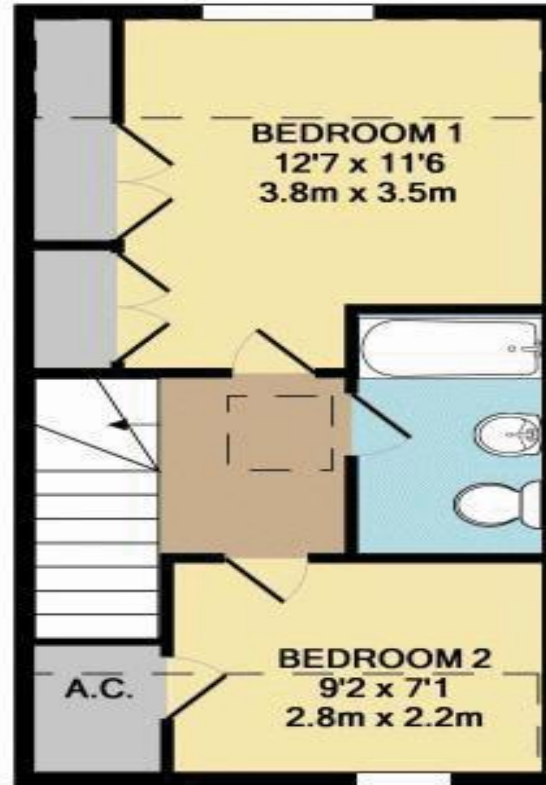

1ST FLOOR

- Two bedroom house
- South West facing rear garden
- Two allocated parking space
- Spacious lounge
- Kitchen with gas boiler
- Bathroom
- Rear access to the garden
- Beautiful village location - East Hanney
- Tenure: Freehold

Important Notice

Thomas Merrifield and their clients give notice that:

1. They are not authorised to make or give any representations or warranties in relation to the property either here or elsewhere, either on their own behalf or on behalf of their client or otherwise. They assume no responsibility for any statement that may be made in these particulars. These particulars do not form any part of any offer or contract and must not be relied upon as statements or representations of fact.
2. Any areas, measurements or distances are approximate. The text, photographs and plans are for guidance only and are not necessarily comprehensive. It should not be assumed that the property has all necessary planning, building regulation or other consents and Thomas Merrifield have not tested any services, equipment or facilities. Purchasers must satisfy themselves by inspection or otherwise.

Whilst every attempt has been made to ensure the accuracy of the floor plan contained here, measurements of doors, windows, rooms and any other items are approximate and no responsibility is taken for any error, omission, or mis-statement. This plan is for illustrative purposes only and should be used as such by any prospective purchaser. The services, systems and appliances shown have not been tested and no guarantee as to their operability or efficiency can be given.
Made with Metropix ©2014